

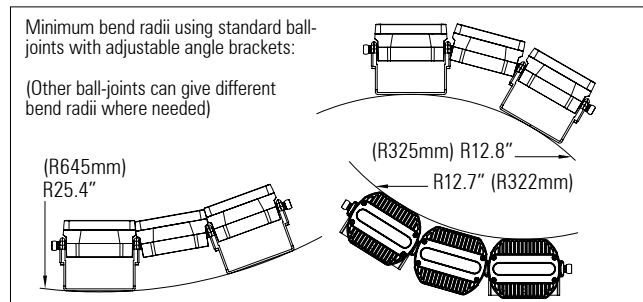

## 3D LED Flex system 100 IP66 Class 2

28 x 0.3 Watt medium power LEDs with white reflector per module

Modular, 3D flexible LED linear lighting system

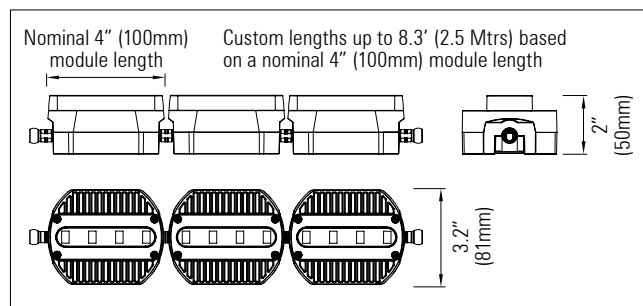

### 28 x 0.3 Watt medium power LEDs with white reflector per module

Modular, 3D flexible LED linear lighting system

#### Product description:

For use in exterior indirect cove lighting applications where the building surfaces are non linear with curved profiles

Each module - 28 x 0.3 Watt Osram, Samsung or Luminus LEDs

Up to 10 Watts per 4" (100mm) module

30 - 48 Volt DC supply

High efficiency white reflector

Flexible in 3 dimensions - Articulated ball-joint system between modules

LED pitch is maintained between the modules

Side, back and end power feed and connector options allow for continuous lighting with no dark areas between fixtures. 17.5 Amp IP68 connectors join fixtures together on-site

Integral LV constant current driver

Dimming options available: 1-10V, DMX and DALI. Separate dimming channel

Various LED colour temperature and CRI options available

Satin black, satin white or any RAL paint colour finish

Custom lengths based on a 4" (100mm) module length up to 8.3' (2.5 mtrs)

Various mounting options and bracket types are available

Up to 2,600 lumens per ft

(Up to 8,700 Lumens per Mtr)

Product Code	No. of LEDs	IP	Length	LED Type	Optics (°)	Colour Temp. (K)	CRI	Cover	Feed	Finish
RAD 3D LED FLEX 100 IP66 0.3W - 28	28 LEDs per 4" (100mm) module:  1" (25mm) pitch between each array of 7 LEDs	66	4" (100mm)  -increments of 4" up to-  8.3' (2.5 mtrs)	0.3W LEDs:  Osram Samsung Luminus	110°	27=2,700k 30=3,000k 35=3,500k 40=4,000k 45=4,500k 50=5,000k Dynamic white	80 90	Clear Frosted	End Back Side	Black White Any RAL colour

## 3D LED Flex system 100 IP66 Class 2

28 x 0.3 Watt medium power LEDs with white reflector per module

Fixed-angle and adjustable-angle mounting bracketry

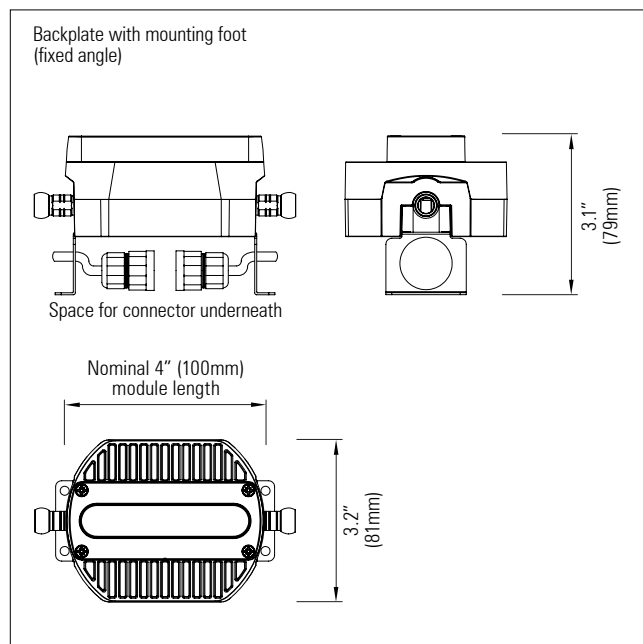

### Fixed-angle and adjustable-angle mounting bracketry for 3D LED Flex 100 IP66. 28 x 0.3 Watt medium power LEDs with white reflector per module

The 3D LED Flex 100 system is flexible in 3 dimensions, which allows it to follow curved building contours

There are a number of bracket options available

Adjustable angle brackets allow the modules to be rotated around the major axis, so that the light output can be aimed precisely

The angle of the modules can be adjusted on-site by hand. The friction ball-joint system keeps the modules correctly positioned. There is also a lockable option, which allows each module to be locked in place using an Allen key once it is correctly positioned

A standard height adjustable angle bracket and a custom height adjustable angle bracket are available

Fixed angle bracket options are also available. The standard fixed angle bracket has a mounting foot which has space for the connectors to fit underneath the modules

Custom options are also available

The brackets are aluminium with a powder coat finish which is available in satin black, satin white or any RAL paint colour finish

The custom height adjustable angle bracket is also available in stainless steel for more demanding exterior applications. Again, this is available with a powder coat finish in satin black, satin white or any RAL colour

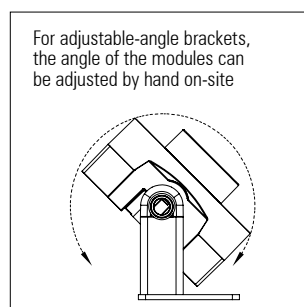
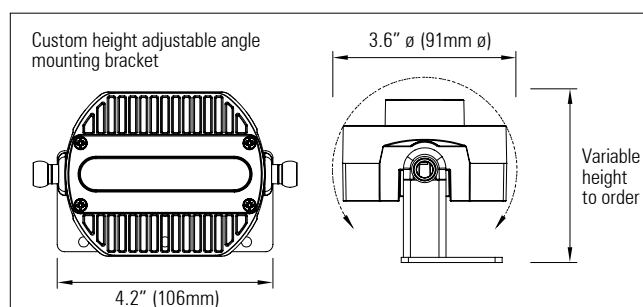
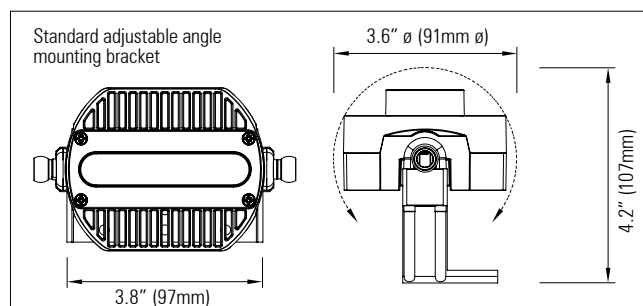

Product code	IP	Finish	Height of legs
RAD 3D LED FLEX 100 IP66 FIXED ANGLE BRACKET WITH MOUNTING FOOT AL	66	Aluminium: Black White Any RAL - colour	Custom height version only: 0.79"
RAD 3D LED FLEX 100 IP66 ADJUSTABLE ANGLE BRACKET STANDARD AL		Stainless steel: Black White Any RAL - colour	-increments of 0.2" up to-
RAD 3D LED FLEX 100 IP66 ADJUSTABLE ANGLE BRACKET CUSTOM HEIGHT SS			11.8"

## 3D LED Flex system 100 IP66 Class 2

### Anti-glare accessories



#### 3D LED FLEX 100 anti-glare accessories

For use with the 3D LED Flex 100 system to control light glare from the LEDs when the fixtures are not fully recessed

3 blade, 1 blade and no blade snoots are available

Satin black, satin white or any RAL paint colour finish. Two colour versions are also available - eg. white finish on exterior & black finish on interior of snoot. Both interior and exterior parts can be any RAL colour paint finish, or any anodised finish

Custom height to order. Straight or any custom cut angle side-profile to order

All snoots can be ordered to custom heights and have any angled side-profile

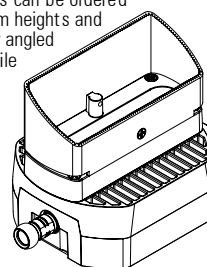

Variable angle to order

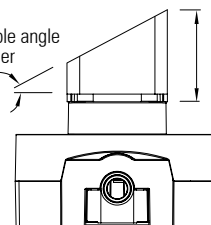

Variable height to order

3 blade snoot  
Available in one or two colour versions

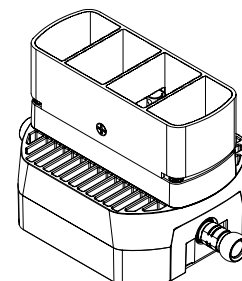
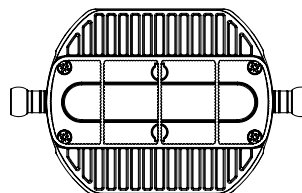

1 blade snoot  
Available in one or two colour versions

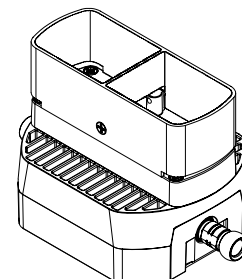
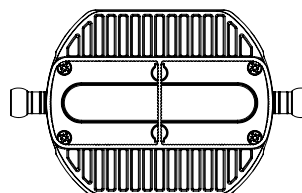

No blade snoot  
Available in one or two colour versions

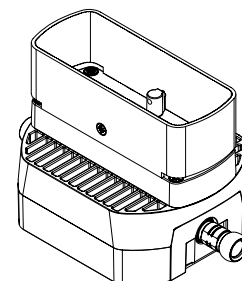
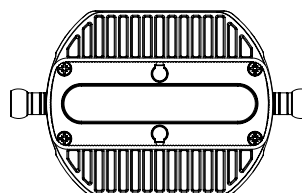

Two colour snoots - The finish of the interior louvre section can be different from the outer finish of the fixture. E.g. white exterior body finish with black interior louvre section

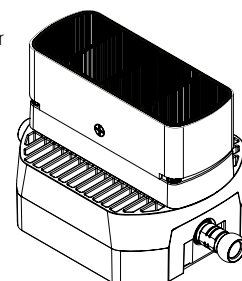
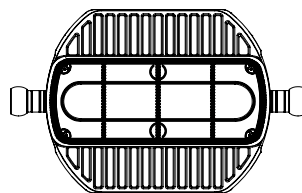

Product Code	No. of blades	IP	Height	Cut angle of side-profile (°)	Finish
RAD 3D LED FLEX 100 SNOOT	0 1 3	66	0.8" (20mm) -increments of 0.2" (5mm) up to- 12" (305mm)	0° -increments of 5° up to- 75°	Black White Any RAL colour  Two colour - both parts can be any anodised or any RAL colour

## 3D LED Flex 100 System Class 2

### Ball-joint types

#### Product description:

Radiant's 3D LED Flex 100 system comprises a patented articulated ball-joint system which links the heatsink modules.

The ball-joints system allows the strips to bend and twist in 3 dimensions, so that they can follow any building contours, whilst maintaining a constant LED pitch.

There are various types of ball-joint to suit different applications, some of which can be seen on this data sheet. Please contact Radiant to discuss custom solutions.

Product Code	Material	Length
STANDARD BALL-JOINT BALL-JOINT TIGHT BENDS BALL-JOINT LONG	Nickel-plated brass	(For longer ball-joints)  3.9" (100mm) 7.9" (200mm) 11.8" (300mm)  Custom lengths

